

INOAC DUCTS & ACCESSORIES



Pipe Duct & Accessories

INOAC - Duct & Accessories

- Inoac's duct and large range of accessories will save contractors time due to ease of installation plus ensures a perfect & professional finish.
- Inoac duct and accessories are made of rigid P.V.C which offers a never changing aspect. The duct and accessories are fade-proof and U.V resistant.
- Thanks to the advantage of P.V.C and its linear structure, they are very harmonious with any type of construction or building offering an outstanding quality finish.
- The easy to install ducts have a bottom and upper section - the bottom is first fixed to the wall. Then fit the pipe, wiring and bind them with the duct saddle tie clips & finally cover them with the snap on upper section.
- All accessories that are two part are supplied with stainless steel screws to prevent rusting and unsightly stains.

Pipe Duct (Ivory)

Airefrig Part Number	Description	Duct Size	Dimensions (mm)					Pcs/box	List Price Excl GST
			A	B	C	D	E		
CD75	Pipe Duct	75	75.5	64	2000	-	-	5	\$25.54
CD100		100	100	70	2000	-	-	5	\$32.59
CD140		140	140	80	2000	-	-	5	\$38.98

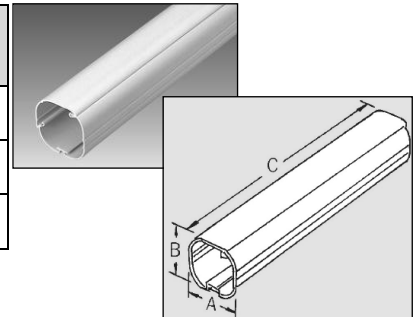

Accessories (Ivory)

Airefrig Part Number	Description	Duct Size	Dimensions (mm)					Pcs/box	List Price Excl GST
			A	B	C	D	E		

NY75	Wall Cover	75	84	67	210	130	83	40	\$5.66
NY100		100	106	70	230	141	93	20	\$10.30
NY140		140	146	80	285	182	102	5	\$17.30

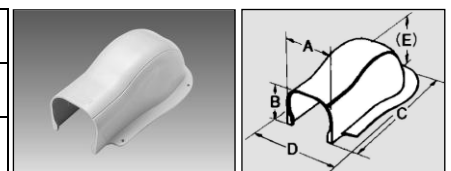

NA75	Corner Cap	75	84	70	66	124	124	20	\$5.15
NA100		100	109	76	66	149	140	20	\$7.22
NA140		140	148	86	66	189	155	10	\$7.78

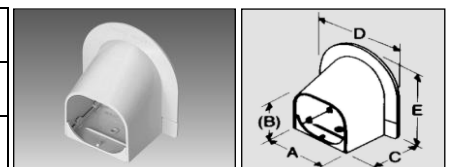

NK75	Wall Cap	75	126	114	16	-	-	80	\$3.70
NK100		100	175	145	16	-	-	40	\$6.05
NK140		140	220	180	16	-	-	20	\$7.73

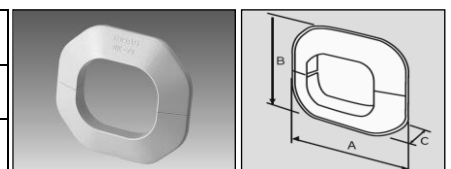

INOAC DUCTS & ACCESSORIES

Accessories (Ivory) cont'd

Airefrig Part Number	Description	Duct Size	Dimensions (mm)					Pcs/box	List Price Excl GST	Image	Diagram
			A	B	C	D	E				
NE75	Elbow 90° (Horizontal)	75	82	69	141	-	-	40	\$9.97		
NE100		100	107	75	161	-	-	20	\$12.15		
NE140		140	146	85	200	-	-	5	\$18.70		
NH75	Mini Elbow 90° (Horizontal)	75	82	69	100	-	-	40	\$5.71		
NH100		100	107	75	125	-	-	20	\$8.29		
NH140		140	146	85	165	-	-	5	\$13.05		
NX75	Elbow 45° to 90° Adjustable (Horizontal)	75	82	69	153	-	-	40	\$7.73		
NX100		100	107	75	193.5	-	-	20	\$13.55		
NX140		140	146	85	248	-	-	5	\$19.21		
NM75	Elbow 45° (Horizontal)	75	82	69	74	-	-	40	\$6.22		
NM100		100	107	75	84	-	-	20	\$8.34		
NM140		140	146	85	106	-	-	5	\$12.32		
NC75	Elbow 90° (Vertical)	75	82	69	124	-	-	40	\$7.67		
NC100		100	107	75	135	-	-	20	\$12.21		
NC140		140	146	85	149	-	-	5	\$15.23		
NL75	Mini Elbow 90° (Vertical)	75	82	69	83	-	-	10	\$8.79		
NL100		100	107	75	90	-	-	5	\$10.58		
NL140		140	146	85	100	-	-	5	\$12.10		
NZ75	Elbow 45° to 90° Adjustable (Vertical)	75	82	69	122	-	-	40	\$8.40		
NZ100		100	105	73	117	-	-	5	\$10.08		
NZ140		140	146	87	150	-	-	5	\$13.22		
NU75	Elbow 45° (Vertical)	75	82	69	72	-	-	40	\$5.10		
NU100		100	107	75	83	-	-	20	\$6.27		
NU140		140	146	85	93	-	-	10	\$13.78		
NCX75	Elbow twists 360° (For Vertical or Horizontal use)	75	80	68	114	-	-	10	\$6.10		
NCX100		100	107	75	135	-	-	20	\$10.08		
NCX140		140	146	87	190	-	-	5	\$15.51		

INOAC DUCTS & ACCESSORIES

Accessories (Ivory) cont'd

Airefrig Part Number	Description	Duct Size	Dimensions (mm)					Pcs/box	List Price Excl GST
			A	B	C	D	E		

NT75	T-Joint	75	82	69	121	160	25	10	\$13.78
NT100	c/w 2 x reducers 100 to 75 (NT100)	100	107	75	161	210	35	5	\$17.98
NT140	c/w 2 x reducers 100 to 75 (NT140)	140	146	85	200	254	35	5	\$27.72

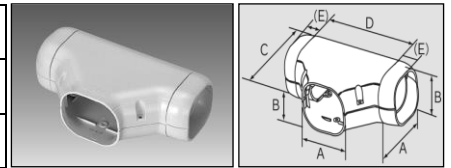

NR75	Duct End Socket	75	53	30	99	82	69	40	\$4.14
NR100		100	53	30	115	107	75	20	\$5.77
NR140		140	53	30	143	146	85	10	\$8.51

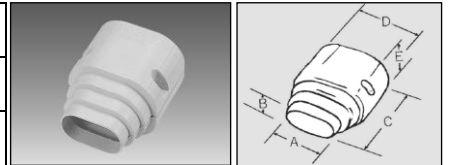

NS75	Duct Connector Socket	75	82	69	80	-	-	40	\$3.14
NS100		100	107	75	80	-	-	20	\$6.10
NS140		140	146	85	80	-	-	10	\$6.16

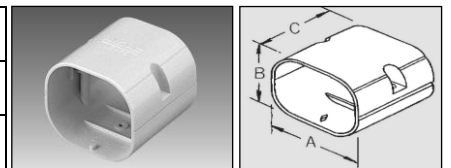

NJ75100	Duct Reducer Socket	75 to 100	86	72	80	107	75	40	\$5.26
NJ100140		100 to 140	115	78	80	146	85	40	\$7.17

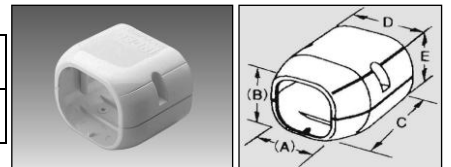

NF75	Flexible Joint	75	76	64	60	550	-	10	\$6.78
NF75M		75	76	64	60	1000	-	10	\$10.81
NF100	(made from Polyethylene)	100	101	70	75	800	-	10	\$13.61
NF140		140	140	80	80	1000	-	5	\$29.68

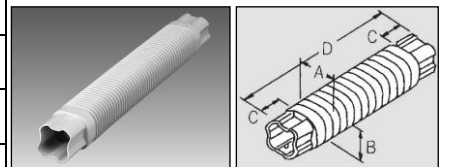

NQF75	Twisted & Flexible Elbow	75	76	6	1000	8	-	5	\$23.02
NQF100		100	101	6	1000	10	-	5	\$28.17

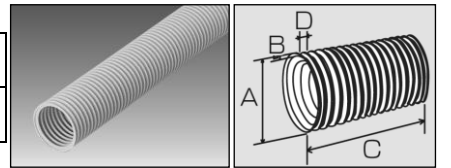

NQ75	Twisted Elbow Socket	75	82	69	90	85.5	-	10	\$6.66
NQ100		100	107	75	102	94	-	5	\$12.60

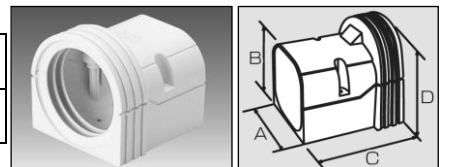

NQJ75	Twisted Elbow Joint	75	88	54	-	-	-	10	\$6.72
NQJ100		100	113	63	-	-	-	5	\$9.41

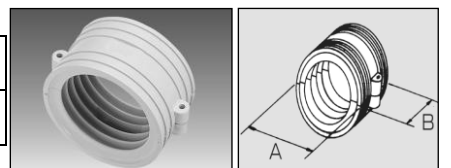

NVS	Duct Saddle Clip & Tie	75	250mm (long) nylon tie					500	\$2.35
NVL		100 & 140	360mm (long) nylon tie					500	\$2.80



INOAC DUCTS & ACCESSORIES

Accessories (cont'd)

Airefrig Part Number	Description	Colour	Maximum Load	Weight	Dimensions (mm)			Pieces per Box	List Price Excl GST
					Height	Width	Length		
DSD400N	Base Rock Stand (PVC resin)	Ivory	120kg (at +50°C)	670 grams	82	83	400	30	\$12.32
DSD1000N				1675 grams	82	83	1000	10	\$26.77



Accessories (cont'd)

Airefrig Part Number	Description	Colour	Pieces per Box	List Price Excl GST
DSDEC	End Cap to suit the Base Rock Stands	Ivory	-	\$0.90

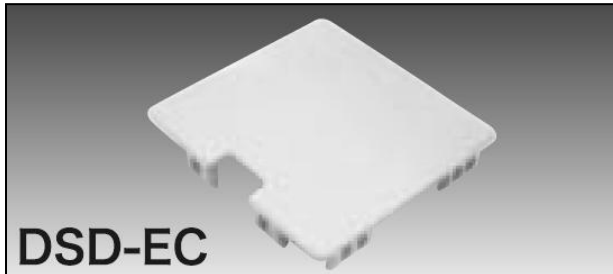

Accessories (cont'd)

Airefrig Part Number	Description	Pieces per Box	List Price Excl GST
DSDMP	Metal Fixing Plate to suit the Base Rock Stands	-	\$0.73

